

# D-4AD

Reja y marco imbornal abatible D-400.

Revision: 01 - 09/11/2018

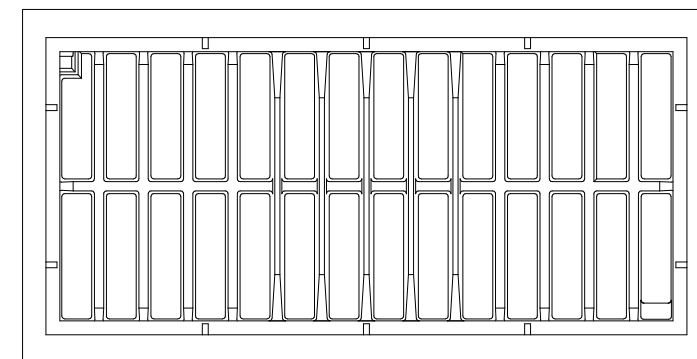
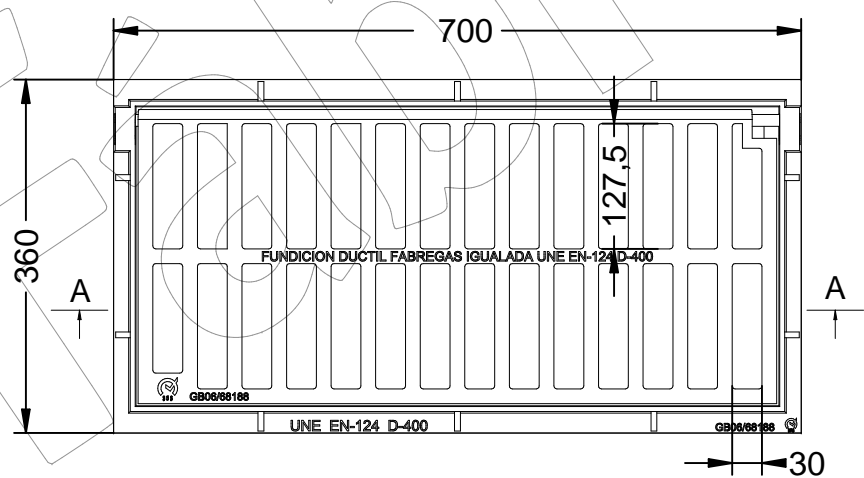
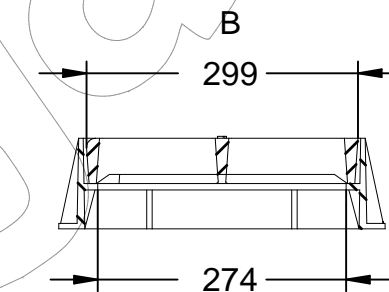
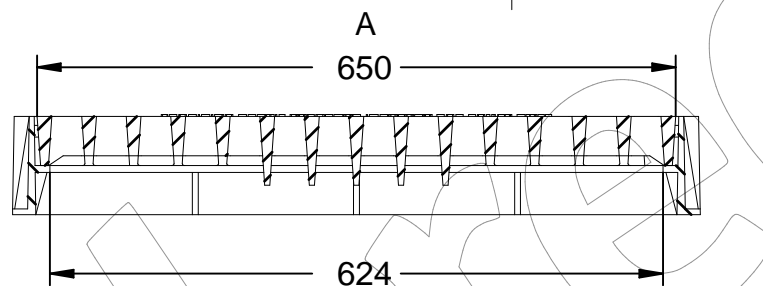
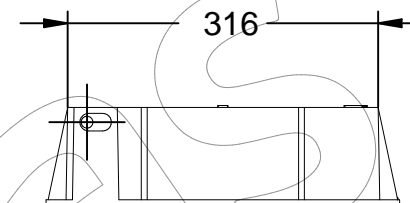
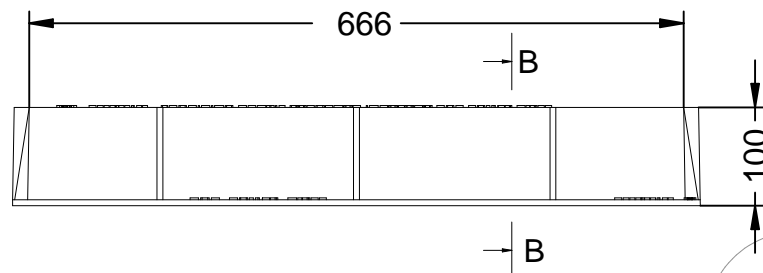

## D-4AD

Reja y marco imbornal abatible D-400.

Revision: 01 - 09/11/2018



**-ES-** 

Descripción: Reja y marco imbornal abatible D-400.

Material: Fundición Dúctil EN-GJS-500-7.

Acabado: Pintado negro asfáltico.

Norma: UNE-EN 124.

Clase: D-400.

Embalaje: Paletizado y plastificado.

Superficie de absorción: 1071,13 cm<sup>2</sup>.

**-EN-** 

Description: Rectangular grating and frame D-400.

Material: Ductile cast iron EN-GJS-500-7.

Paint finish: Painted black asphalt.

Standard: UNE-EN 124.

Class: D-400.

Packing: Palletized and plasticized.

Absorption surface: 1071,13 cm<sup>2</sup>.

**-PT-** 

Descrição: Grade retangular e moldura D-400.

Material: Ferro fundido dúctil EN-GJS-500-7.

Acabamento: Asfalto preto pintado.

Norma: UNE-EN 124.

Classe: D-400

Embalagem: Paletizado e plastificado.

Superfície de absorção: 1071,13 cm<sup>2</sup>.

**-CA-** 

Descripció: Reixa i marc embornal abatible D-400.

Material: Fosa Dúctil A-GJS-500-7.

Acabat: Pintat negre asfàtic.

Norma: UNE-EN 124.

Classe: D-400.

Embalatge: Paletitzat i plastificat.

Superfície d'absorció: 1071,13 cm<sup>2</sup>.

**-FR-** 

Description: Caillebotis rectangulaire et cadre D-400.

Matériau: Fonte ductile EN-GJS-500-7.

Finition: Asphalte noir peint.

Norme: UNE-EN 124.

Classe: D-400.

Emballage: Palettisé et plastifié.

Surface d'absorption: 1071,13 cm<sup>2</sup>.